



TC Fluid Control Ltd
 Instrumentation +44 (0) 1322 622 400
 www.tc-fluidcontrol.com



INSTALLATION AND SERVICE GUIDE

KLINGER Transparent Level Gauges for saturated steam

Model ST 21 - ST40 - T160 with "D" type cocks

1 COMMISSIONING

To minimise thermal shock to gauge glass .

Thermal shock considerably affects the life and performance of the glasses. If a complete plant is being commissioned, thermal shock is generally not too great for the gauge, as long as the gauge cocks are left in the OPEN POSITION. If the gauge has been isolated for maintenance, while the rest of the plant is under temperature and pressure, then the following procedure is recommended to bring the gauge back into service

1.1 With the top and bottom cocks shut, open the drain cock then crack the top cock to allow a small flow of steam to pass through the gauge until working temperature is attained.

1.2 Close drain cock allowing the resulting condensate to gradually fill the gauge.

1.3 Open the top cock fully.

1.4 Open the bottom cock fully.

1.5 During the commissioning period, the covers and their joints could settle, and it is essential therefore to follow up all clamping bolts to maintain the required torque (for correct order and torque see tightening procedure).

The tightening nut on the stuffing boxes, and the top and bottom cocks should also be followed up (the plug should be in the OPEN POSITION during this operation)

TIGHTENING PROCEDURE

Cover nut	daN.m	lbs.ft
ST 21 - MT - UT - ST 40 - T 40	5	36

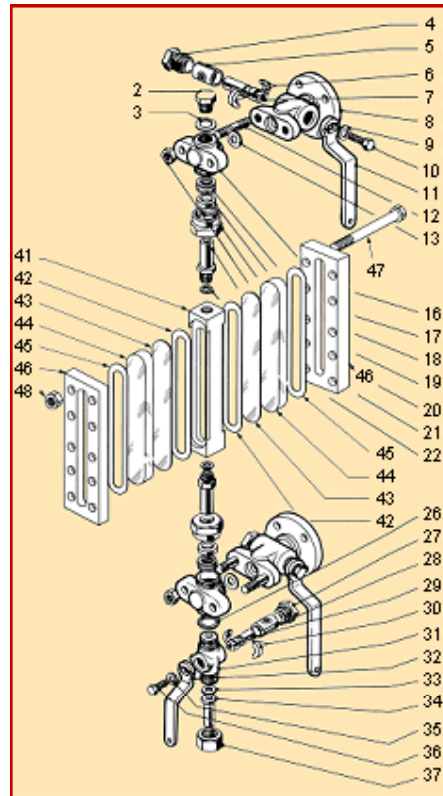
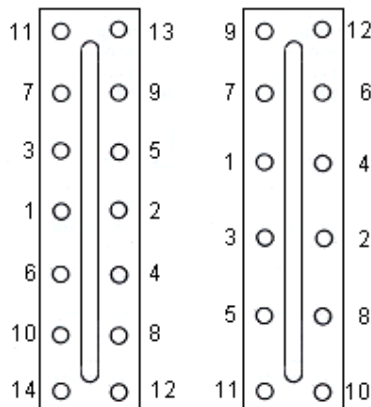

Item	Part list	Item	Part list
2	Plug 1/2"	27	Tightening nut
3	Plug joint 1/2"	28	Packing sleeve AB 12
4	Tightening nut AB 18	29	Plug AB 12
5	Packing sleeve AB 18	30	Split ring AB 12
6	Split ring AB 18	31	Drain cock body
7	Plug AB 18	32	Lever AB 12
8	Cock body	33	Union tailpipe joint
9	Lever washer	34	Union tailpipe
10	Lever screw	35	Gland ring
11	Lever AB 18	36	Lever screw
12	Stud	37	Union tailpipe nut
13	Stuffing box joint	41	Body
16	Stuffing box	42	Sealing joint
17	KU graphit ring	43	Mica
18	Packing ring	44	Flat glass
19	Stuf.box tightening nut	45	Cushion joint
20	M 12 nut	46	Covers
21	Tube 16 mm	47	Screw HM 12
22	Joint	48	Nut
26	Joint 1/2"		

Further information

For further information, please send an E-mail to the following address: instruments@tc-fluidcontrol.com

The characteristics of the products described on this page may be modified without notice, in the interests of regular improvement. In addition, the technical data reproduced here is provided for information only.

